

3-D LASER SCAN: LEASE SPACE INVENTORY/AS-BUILT

Westlake use 3-D scanning to collect information about every visible surface within a commercial office lease space. The scans were merged to provide an inventory of the various offices and open spaces. The raw data was available for easy reference, for dimensioning, for planning tenant improvements, and for preparation of AutoCAD as-built drawings.

- Individual scans capture site information with 'photo realistic' quality. Depending on the density (detail) required, the actual scan time can vary from 30 seconds to 7 minutes per scan.
- Multiple scans can be combined to provide a complete facility inventory. All data can be tied to a building grid, survey control, or other coordinate system. In this instance, we used the common walls to relate the scans to each other.
- The "raw scan data" can be visited from the desk-top as needed. From the raw data, dimensions can be taken in using various tools, including a free viewer. [All data consists of 3-D coordinates in a common control system.]

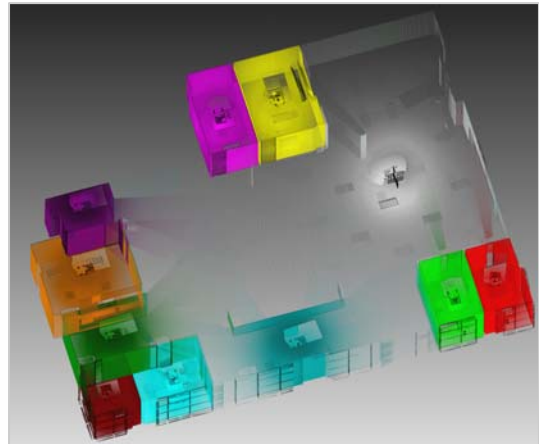

Above - Each color represents an individual scan. When combined, the scans provide a model of the entire space.



Above: - Data for a single room (3D view).

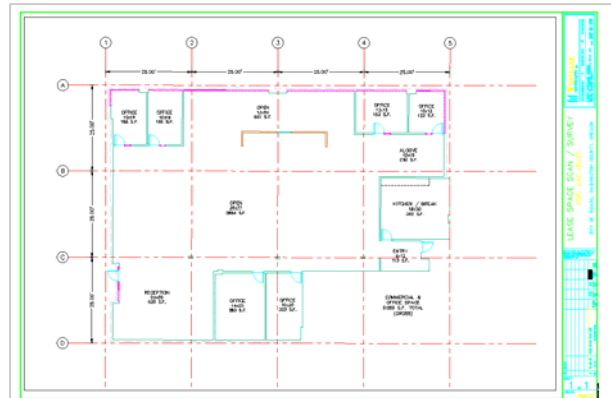

Above - Scan data transferred to AutoCAD to create drawings for planning and redesign.



Left - The actual scans are spherical and appear curved when depicted as flat images (planar view).